

# TORQUE WRENCHES



Digital torque wrenches  
P.80 ►



Digital torque wrenches  
Adjustable wrench type  
P.81 ►



Mechanical torque wrenches  
P.82 ►

# DIGITAL TORQUE WRENCH

## “Digital of torque management” Record and manage operation results

- Memory storage of 2,000 data
- Cable type torque management system
- Dedicated software included

### Accuracy

[Ratchet wrench type]  
Right :  $\pm 2\%$   
Left :  $\pm 3\%$   
[Adjustable wrench type]  
Right :  $\pm 3\%$   
Left :  $\pm 4\%$



■ Resin case as standard acc.  
Dedicated resin case for convenient storage and transport.



### ■ Notifying function

The LED indicator, the buzzer sound and the LCD display notify the situation against the set torque value.

### ■ Measurement modes switch function

You can measure with tracking mode or peak hold mode.

### ■ Adapted to both left and right direction measuring

### ■ Super light-weight design

1/2 to 1/3 lighter than a usual mechanical torque wrench.

### ■ Pass or fail notification

Against torque value you can set in advance (up to 9), a pass or fail judgement with 0~25% tolerance range up and down separately is available.

### ■ Calibration certificate included

### Adjustable wrench type : extra features

### ■ Correction function when the ratchet head is replaced

■ **Special shape** Thanks to a special design, the measuring position is almost the same even when the size of bolts and nuts to be tightened are different.



### ■ Tightening condition notification

The 2 colors LED lamp, the buzzer sound and the LCD display notify the tightening condition. When the tightening reaches 80% of the torque target, the LED lamp starts to light and the buzzer starts to sound intermittently. LED lamp : as the target torque is being approached, the LED lamps are lighting up in turn.



### ■ Specially shaped adjustable angle wrench

Thanks to a special design, the measuring position is almost the same even when the size of bolts and nuts to be tightened are different.

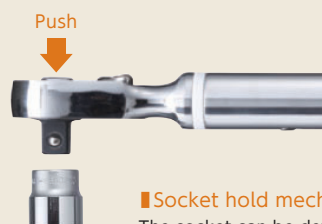

### ■ Socket hold mechanism

The socket can be detached with a one-push operation. The socket is easy to replace, and doesn't come off easily during operation.



### ■ USB cable transmission

After the operation, the data are transferred and stored on the PC with the USB cable included.

## DTRH

### DIGITAL TORQUE WRENCH (Cable Type)



Item No.	Torque measuring range(N·m)	Min. display unit (N·m)	Square drive(mm)	Size(mm)					N.W. (kg)
				Body max. width	L	H	T	T1	
<b>DTRH3030</b>	6(1.5)~30	0.01	9.5	47	221	22.5	40	10.4	0.42
<b>DTRH3060</b>	12(3)~60	0.01	9.5	47	230	31.5	40	14.4	0.49
<b>DTRH3085</b>	17(4.2)~85	0.1	9.5	47	271	31.5	40	14.4	0.54
<b>DTRH3135</b>	27(6.8)~135	0.1	9.5	47	380	31.5	40	14.4	0.69
<b>DTRH4135</b>	27(6.8)~135	0.1	12.7	47	380	31.5	40	14.4	0.71
<b>DTRH4200</b>	40(10)~200	0.1	12.7	40	520	41.5	45	18.0	1.31
<b>DTRH4340</b>	68(17.5)~340	0.1	12.7	40	640	41.5	45	18.0	1.48

\* Figures in ( ) are the minimum values for measurement, but not covered by accuracy. \* AAA battery 2pcs included (for DTRH4200/4340, AA battery 2pcs)

## DTMW

### DIGITAL TORQUE WRENCH, ADJUSTABLE ANGLE WRENCH TYPE (Cable Type)



Item No.	Torque measuring range(N·m)	Min. display unit (N·m)	Size(mm)						N.W. (kg)
			Jaw opening	Body max. width	L	H	T	T1	
<b>DTMW30085</b>	20.6(5.1)~103	0.1	5~30	47	314	61	40	6.4	0.60
<b>DTMW30135</b>	30.7(7.7)~153.4	0.1	5~30	39	467	71	45	7.7	1.06
<b>DTMW41200</b>	44.7(11.2)~223.4	0.1	10~41	39	575	87	45	9.0	1.50

\* Figures in ( ) are the minimum values for measurement, but not covered by accuracy. \* AAA battery 2pcs included (for DTMW30135/41200, AA battery 2pcs)

## DTMW-H

### ADJUSTABLE ANGLE WRENCH HEAD FOR DIGITAL TORQUE WRENCH, ADJUSTABLE ANGLE WRENCH TYPE

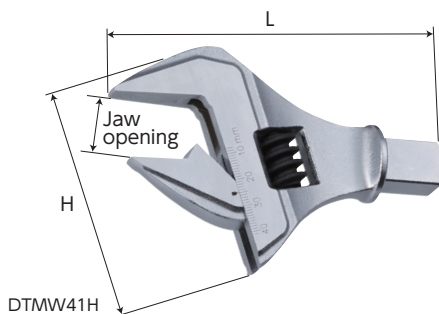

Item No.	Size(mm)			Applicable item No.	N.W. (g)
	Jaw opening	L	H		
<b>DTMW30H</b>	5~30	103	70	DTMW30085·30135	245
<b>DTMW41H</b>	10~41	130	88	DTMW41200	425

## DTMW-HS • DTMW-HB

### RATCHET HEAD FOR DIGITAL TORQUE WRENCH, ADJUSTABLE ANGLE WRENCH TYPE

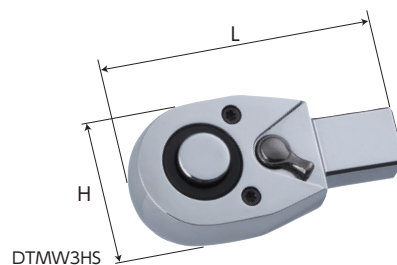

Item No.	Square drive (mm)	Size(mm)		Applicable item No.	N.W. (g)
		L	H		
<b>DTMW3HS</b>	9.5	60	32	DTMW30085·30135	155
<b>DTMW4HS</b>	12.7	60	32	DTMW30085·30135	170
<b>DTMW4HB</b>	12.7	80	39	DTMW41200	305

# MECHANICAL TORQUE WRENCH

For measuring in both right and left directions

- Torque set value lock function
- Double scale display
- Calibration certificate included

**Accuracy**

Right :  $\pm 3\%$   
Left :  $\pm 6\%$

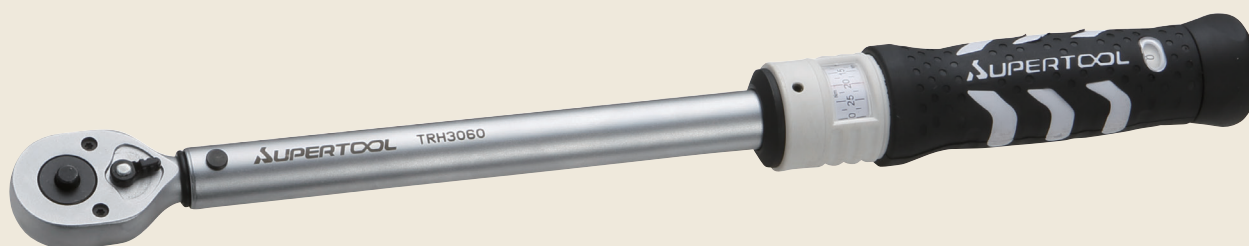

TRH3060

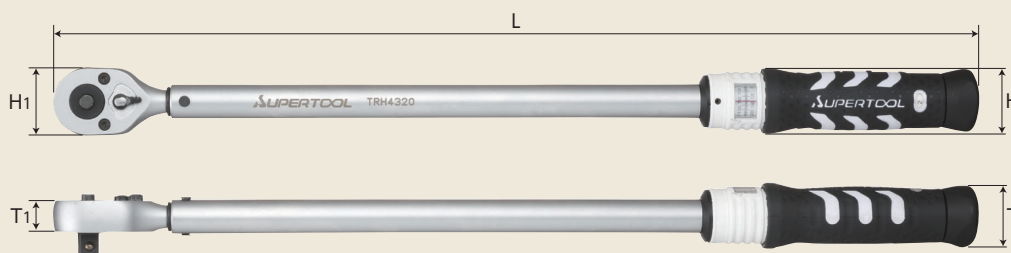

■ Resin case as standard acc.

Dedicated resin case for convenient storage and transport.

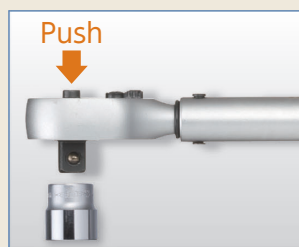

Socket hold mechanism



Torque set value lock function

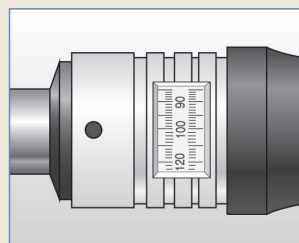

Double scale display for good recognition



Item No.	Torque measuring range(N·m)	Min. display unit (N·m)	Square drive (mm)	Size(mm)					N.W. (kg)
				L	H	H1	T	T1	
<b>TRH3060</b>	10~60	0.5	9.5	427	42	37	42	15.4	1.15
<b>TRH3100</b>	20~100	0.5	9.5	462	42	37	42	15.4	1.50
<b>TRH4200</b>	40~200	1.0	12.7	517	42	44	42	20.0	2.20
<b>TRH4320</b>	60~320	2.0	12.7	586	42	44	42	20.0	2.30

\* Ratchet head gear number : 32