

C-SHAPED CLAMP (Bahco type)



Cation paint

(Excellent rust proofing)

BC 25 ~ 300

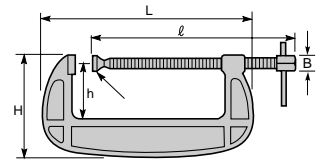

The handle is attached for quick tightening and sufficient to tighten wooden materials. Tightening of the hexagonal screw with a wrench ensures a strong closure. (Unit: mm)

Item No.	Size	Maximum opening	L	ℓ	H	h	B	Weight (g)	Remarks
BC 25	25	26.5	78	80	60	26	12	200	
BC 38	38	40.0	99	98	69	31	12	300	
BC 50	50	52.0	118	118	78	36	14	450	
BC 75	75	77.5	157	152	96	46	17	800	
BC 100	100	103.0	197	190	114	56	17	1,300	
BC 125	125	128.5	237	225	131	66	19	1,700	
BC 150	150	154.0	276	262	149	76	22	2,800	
BC 200	200	205.0	346	324	174	92	22	4,200	
BC 250	250	255.5	415	386	204	108	27	7,000	
BC 300	300	306.5	485	451	230	124	27	9,000	

The adaptor (Screw tip plate) is replaceable. (BC50 ~ 300)

C-SHAPED CLAMP (Heavy duty light-weight and wide type)



New series

Cation paint

(Excellent rust proofing)

EC 50 ~ 200

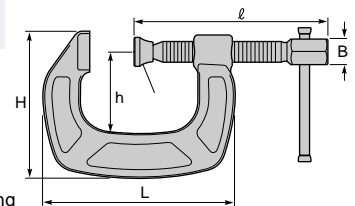

Deep working range and light type. The handle is attached for quick tightening and tightening of the hexagonal blade angle a wrench ensures a strong closure. (Unit: mm)

Item No.	Size	Maximum opening	L	ℓ	H	h	B	Weight (g)	Remarks
EC 50	50	57	130	132	99	55	17	0.65	
EC 75	75	82	172	170	134	80	17	1.3	
EC 100	100	107	213	207	168	105	19	2.2	
EC 125	125	132	251	243	204	130	22	3.5	
EC 150	150	157	298	281	239	155	22	5.5	
EC 200	200	209	381	348	306	205	27	9.5	

The adaptor (Screw tip plate) is replaceable. (All the size)

C-SHAPED CLAMP (Heavy duty wide type)



Cation paint

(Excellent rust proofing)

CC 50 ~ 200

Deep working range and heavy duty type. The handle is attached for quick tightening and tightening of the hexagonal blade angle a wrench ensures a strong closure. (Unit: mm)

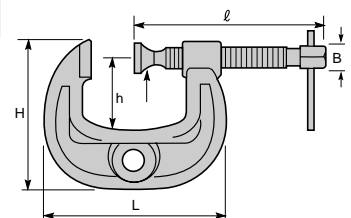

Item No.	Size	Maximum opening	L	ℓ	H	h	B	Weight (g)	Remarks
CC 50	50	53.0	140	134	116	55	17	1.1	
CC 75	75	78.0	182	165	152	80	19	1.9	
CC 100	100	103.0	225	201	189	105	21	2.9	
CC 125	125	128.0	267	237	225	130	22	4.3	
CC 150	150	153.0	310	269	262	155	24	6.0	
CC 200	200	204.0	395	336	335	205	27	12.0	

The adaptor (Screw tip plate) is replaceable. (All the size)

C-SHAPED CLAMP (Standard type)



BC 50M ~ 100M

The handle is attached for quick tightening and sufficient to tighten wood materials. Tightening of the hexagonal screw with a wrench ensures a strong closure. (Unit: mm)

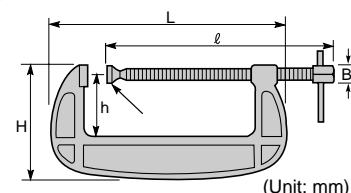

Item No.	Size	Maximum opening	L	ℓ	H	h	B	Weight (g)	Remarks
BC 50M	50	52.0	118	118	78	36	14	0.45	
BC 75M	75	77.5	157	152	96	46	17	0.8	
BC 100M	100	103.0	197	190	114	56	17	1.3	

The adaptor (screw tip plate) is replaceable. (All the sizes)
Body finish : Nickel-plated