

FLARING TOOL SET, Eccentric cone type PAT.



TF 455WN · 456WN

Feed handle type (Manual)

for New cooling media

Clutch mechanism for preventing over load.

Flaring cone →
The precision finished flaring cone, using eccentric rotation, allows neat and even flaring through low force due to the even flaring of the cone.

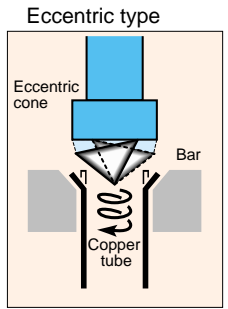

(Unit : inch)

Item No.	Applicable diameter of tube Mild copper and Aluminum pipe	Set weight (kg)	Remarks
TF 455WN	1/4 · 3/8 · 1/2 · 5/8 · 3/4	1.5	
TF 456WN	1/4 · 5/16 · 3/8 · 1/2 · 5/8 · 3/4	1.6	

FLARING TOOL SET, Eccentric cone type PAT.



TF 455WQN · 456WQN

for New cooling media

Quick handle type

No need to change handle due to quick handle and capable of steering consecutive rotation easily.

Reversible switch is typed by quick switch sliding up and down the handle. Backlashless by using special bearing in a part of rotation in the handle. It uses clutch system acceptable to the heat, and complete precision flaring.

Example of use

(Unit : inch)

Item No.	Applicable diameter of tube Mild copper and Aluminum pipe	Set weight (kg)	Remarks
TF 455WQN	1/4 · 3/8 · 1/2 · 5/8 · 3/4	1.7	
TF 456WQN	1/4 · 5/16 · 3/8 · 1/2 · 5/8 · 3/4	1.7	

FLARING TOOL SET, Eccentric cone type PAT.



TF 455WQH · 456WQH

for New cooling media available to new standard

Quick handle type

No need to change handle due to quick handle and capable of steering consecutive rotation easily.

Reversible switch is typed by quick switch sliding up and down the handle. Backlashless by using special bearing in a part of rotation in the handle. It uses clutch system acceptable to the heat, and complete precision flaring.

Example of use

(Unit : inch)



Item No.	Applicable diameter of tube Mild copper and Aluminum pipe	Set weight (kg)	Remarks
TF 455WQH	1/4 · 3/8 · 1/2 · 5/8 · 3/4	1.7	
TF 456WQH	1/4 · 5/16 · 3/8 · 1/2 · 5/8 · 3/4	1.7	

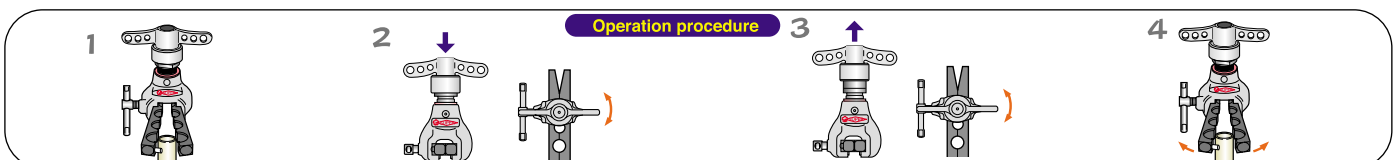



FLARING TOOL SET, Eccentric cone type PAT.



TF 455WH · 456WH

Copper pipe 3/4", inner diameter 1.2mm

for New cooling media
available to new standard

Feed handle type
(Manual)

Flaring cone →

The precision finished flaring cone, using eccentric rotation, allows neat and even flaring through low force due to the even flaring of the cone.

Clutch mechanism for preventing over load.

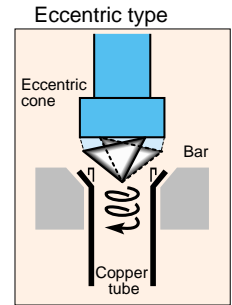

(Unit : inch)

Item No.	Applicable diameter of tube Mild copper and Aluminum pipe	Set weight (kg)	Remarks
TF 455WH	1/4 · 3/8 · 1/2 · 5/8 · 3/4	1.5	
TF 456WH	1/4 · 5/16 · 3/8 · 1/2 · 5/8 · 3/4	1.6	

FLARING TOOL SET, Eccentric cone type PAT.



TF 455WRH · 456WRH

Copper pipe 3/4", inner diameter 1.2mm

for New cooling media
available to new standard

Ratchet handle type

Flaring tool ratchet handle attached.

The ratchet mechanism enables a speedy finish with ease.

Clutch mechanism for preventing over load.

(Unit : inch)

Item No.	Applicable diameter of tube Mild copper and Aluminum pipe	Set weight (kg)	Remarks
TF 455WRH	1/4 · 3/8 · 1/2 · 5/8 · 3/4	1.8	
TF 456WRH	1/4 · 5/16 · 3/8 · 1/2 · 5/8 · 3/4	1.8	

FLARING TOOL SET, Eccentric cone type PAT.



TF 455WDH · 456WDH

Copper pipe 3/4", inner diameter 1.2mm

for New cooling media
available to new standard

For manual and electric type

Clutch mechanism for preventing over load.

The built-in clutch mechanism safe and speedy electrical operation.

Bit for electric driver attached (3/8" · 8mm)

Example of use



(Unit : inch)

Item No.	Applicable diameter of tube Mild copper and Aluminum pipe	Set weight (kg)	Remarks
TF 455WDH	1/4 · 3/8 · 1/2 · 5/8 · 3/4	1.5	
TF 456WDH	1/4 · 5/16 · 3/8 · 1/2 · 5/8 · 3/4	1.6	