

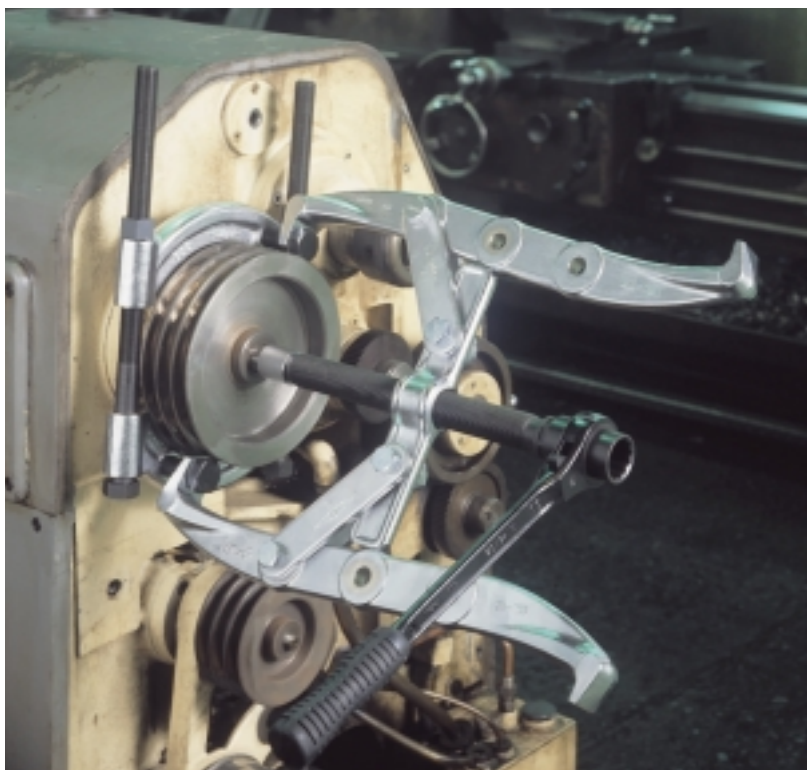

For a variety of work in pulling bearings, pulleys and gears when disassembling and repairing machinery and automobiles.



Gear pullers were first developed by Super tool in 1955.

Since then, in response to users requirements for repairing tools, we have been studying and developing shock pullers (SSP), bearing pullers (BH, BP), armature bearing pullers (AB), etc., to allow easy pulling irrespective of the internal or external diameter of pulleys, gear and bearings.

Since their development, Super tool has been the only all-round manufacturer of pullers in Japan for over half a century.

GEAR PULLERS

GEAR PULLER G Type (Professional use heavy duty type)



G 3 ~ 24

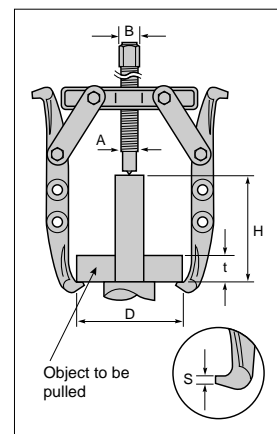

The reaching range of the claws can be expanded by shifting one hole type to two or three holes types.
The steel ball installed in the adaptor significantly reduces friction.

(Unit : mm)

Item No.	D		t When D is Max.	H	S	B	A	Breaking load (kN)	Weight (kg)	Applicable adaptor	Remarks
	Min.	Max.									
G 3	40	75	30	55	3.5	14	12	20	0.4		
G 4	50	100	45	100	4.1	17	14	40	0.8	GA4N	
G 6	60	150	60	150	5.3	19	18	60	1.9	GA6N	
G 8	80	200	100	240	6.7	22	22	80	3.8	GA8N	
G 10	100	250	120	250	7.4	30	28	100	6.0	GA10N	
G 12	120	300	125	275	8.0	32	32	120	9.0	GA12N	
G 15	150	375	130	320	8.7	41	38	150	11.0	GA15N	
G 18	180	450	140	370	9.8	46	44	180	15.0	GA18N	
G 24	280	600	175	575	17.5	46	44	240	45.0	GA24N	

Accessories GP Oil (15g) : All sizes • Single-size ratchet wrench with grip: G 10 ~ 24 • Power pusher: G 15 ~ 24 • Handle for forcing screw: G 3 ~ 8
H indicates the dimension when the forcing screw is lifted to the maximum point.