

ROLL KNURLING HOLDER

with fine knurls (KNP RL0.6)

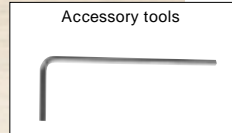
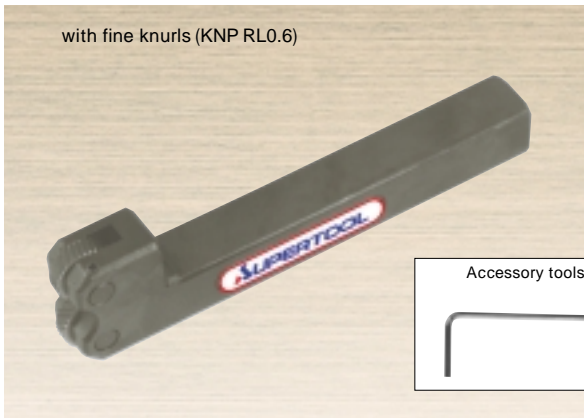

KH10AL·AR·12AL·AR

For processing small material : cross cut

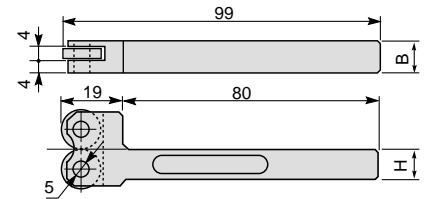

(Unit:mm)

Item No.	H	B	Knurling range	Weight (g)	Applicable knurling wheel
KH 10AL	10	10	3 ~ 30	90	KNP RL1.0 ~ 0.5
KH 12AL	12	12		120	

with fine knurls (KNP RL0.6)

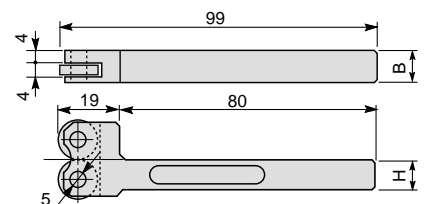

(Unit:mm)

Item No.	H	B	Knurling range	Weight (g)	Applicable knurling wheel
KH 10AR	10	10	3 ~ 30	90	KNP RL1.0 ~ 0.5
KH 12AR	12	12		120	

ROLL KNURLING HOLDER S-MODEL

with fine knurls (KNP F0.6)



KH N1R·L·P1

For processing small material : plain cut

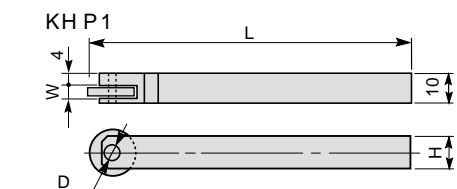
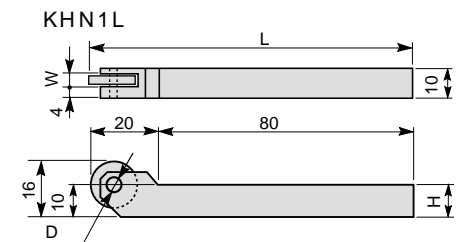
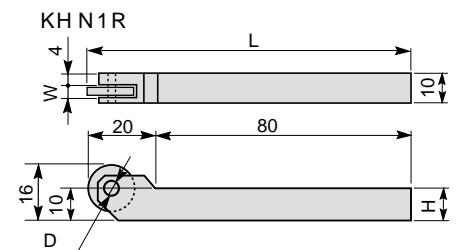

FEATURES

- This is a small diameter size model of roll knurling holder, KH S1type.
- Knurling wheel of 12mm in external diameter is employed and applicable to even small-sized material.
- 2 types of holder with different shank positions (for knurling wheel) are prepared.
 - KH N1R, L---The upper side of the shank corresponds with the center line of knurling wheel.
- KH P type---The center of the shank corresponds with the center line of knurling wheel. One side positioning of knurling wheels enables a processing further to the stepped part.

(Unit:mm)

Item No.	W	D	H	L	Knurling range	Weight (g)	Applicable knurling wheel
KH N1R	4	5	10	100	1.5 ~ 20	75	KNP F1.0 ~ F0.5
KH N1L							
KH P1							