

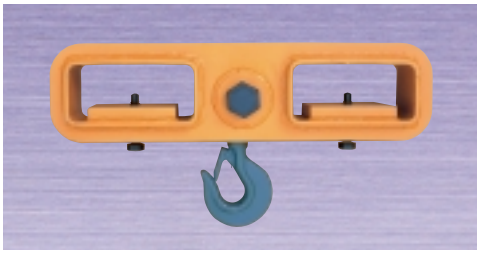

LIFTING HOOK for Fork lift



FLH 1

Balance with hook for fork lift

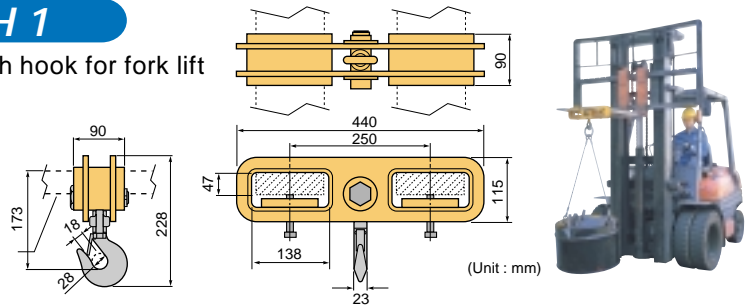

FEATURES

Attaching of the balance will change a fork lift to a mobile crane.
Only tighten the securing bolts to fix the balance.
The latch is attached to the swivel hook for omnidirectional-operation and is vibration-proof.

SPECIFICATIONS

(Unit : mm)

| Item No. | Rated capacity (ton) | Applicable hooks of fork lift (mm) | | Weight (kg) |
|----------|----------------------|------------------------------------|-----------|-------------|
| | | Width | Thickness | |
| FLH 1 | 1 | 70 ~ 120 | 15 ~ 40 | 12 |

PALLET PULLING CLAMP (Customized product)

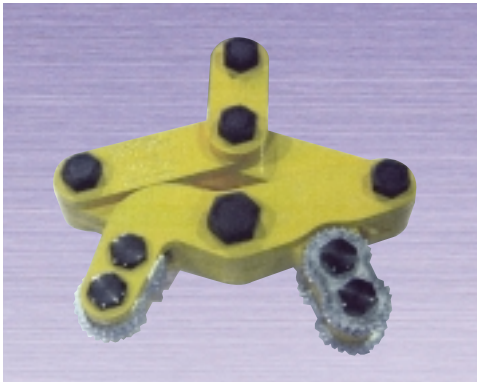

PLC0.5~2

APPLICATIONS

For moving wooden pallets to unload the goods from the box truck.
Clamp for pulling in a loaded pallet from a place unreachable by the fork of a forklift.



SPECIFICATIONS

| Item No. | Rated capacity (ton) | Jaw opening (mm) | Weight (kg) | Remarks |
|----------|----------------------|------------------|-------------|---------|
| PLC 0.5 | 0.5 | 25 ~ 75 | 10 | |
| PLC 1 | 1 | 50 ~ 100 | 13 | |
| PLC 2 | 2 | 75 ~ 125 | 16 | |

CHAIN SLINGS



Dual lifting Chain Slings

Single lifting Chain Sling

CSC 6SS ~ 10S

CSC 6D ~ 10D

FEATURES

- Chain slings can be directly connected to the SUPER lifting clamps.
- These lightweight and durable chain slings are made in accordance with Japanese Industrial Standard.
- Each sling chain is supplied with a tag that gives information on the maximum capacities for specific lifting angles.

Single lifting chain sling, CSC-S series

| Item No. | Full length (mm) | Chain length (mm) | Rated capacity (kg) |
|----------|------------------|-------------------|---------------------|
| CSC 6SS | 780 | 518 | 1000 |
| CSC 6S | 1280 | 1018 | 1000 |
| CSC 8S | 1819 | 1512 | 2000 |
| CSC 10S | 1831 | 1480 | 3000 |

Dual lifting chain slings, CSC-D series

| Item No. | Full length (mm) | Chain length (mm) | Rated capacity for lifting angles under 90° (kg) |
|----------|------------------|-------------------|--|
| CSC 6D | 1779 | 1517 | 1400 |
| CSC 8D | 2311 | 1992 | 2800 |
| CSC 10D | 2387 | 2023 | 4200 |

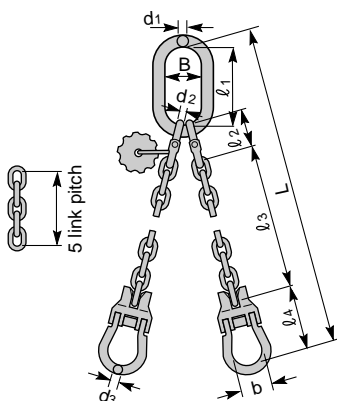

Single lifting Chain Sling CSC-S series

(Unit : mm)

| Item No. | B | b | L | ℓ ₁ | ℓ ₂ | ℓ ₃ | ℓ ₄ | d ₁ | d ₂ | d ₃ | 5 link pitch | Chain diameter |
|----------|----|----|------|----------------|----------------|----------------|----------------|----------------|----------------|----------------|--------------|----------------|
| CSC 6SS | 64 | 34 | 780 | 127 | 47 | 518 | 88 | 13 | 7 | 10 | 96 | 6.3 |
| CSC 6S | 64 | 34 | 1280 | 127 | 47 | 1018 | 88 | 13 | 7 | 10 | 96 | 6.3 |
| CSC 8S | 70 | 45 | 1819 | 140 | 57 | 1512 | 110 | 16 | 9 | 14 | 120 | 8 |
| CSC 10S | 75 | 54 | 1831 | 152 | 70 | 1480 | 129 | 19 | 12 | 18 | 151 | 10 |

Dual lifting Chain Slings CSC-D series

(Unit : mm)

| Item No. | B | b | L | ℓ ₁ | ℓ ₂ | ℓ ₃ | ℓ ₄ | d ₁ | d ₂ | d ₃ | 5 link pitch | Chain diameter |
|----------|----|----|------|----------------|----------------|----------------|----------------|----------------|----------------|----------------|--------------|----------------|
| CSC 6D | 64 | 34 | 1779 | 127 | 47 | 1517 | 88 | 13 | 7 | 10 | 96 | 6.3 |
| CSC 8D | 76 | 45 | 2311 | 152 | 57 | 1992 | 110 | 19 | 9 | 14 | 120 | 8 |
| CSC 10D | 83 | 54 | 2387 | 165 | 70 | 2023 | 129 | 22 | 12 | 18 | 151 | 10 |