

# JIB CRANE (Pillar-fixed / - Bolts and nuts type)

JBC 1520HF ~ 4840HF

Universal-joint type

Boring bolts holes through the pillar of the H-shaped steel in the building and fixing the flange for assembly and installation.

### Feature

Even in the building where the ceiling is comparatively low, the space can be effectively used, since there is no pulling from above. It is easy to assemble and disassemble the arms.

The central joint of the arm can be turned 180 degrees to the right or to the left, effectively securing a wide range of working area.

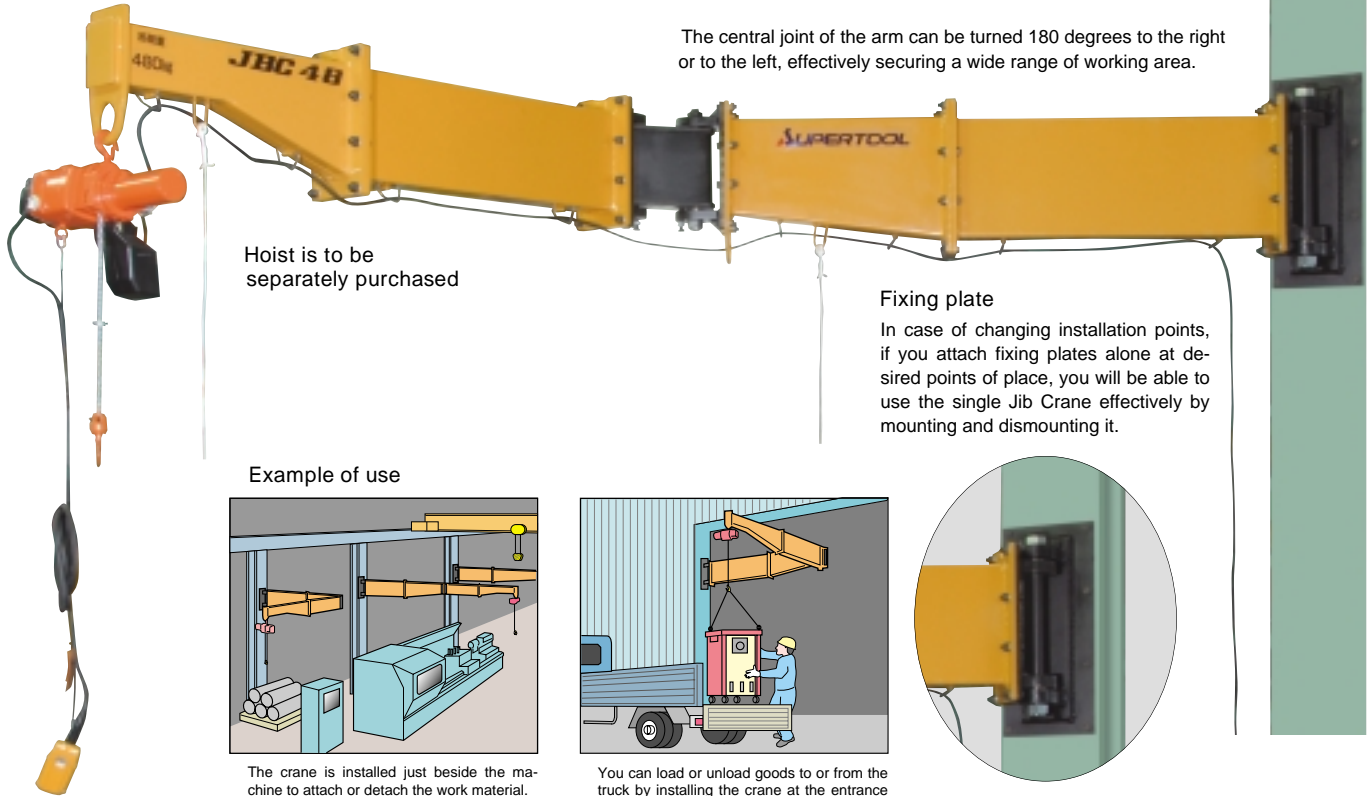

Hoist is to be separately purchased

### Fixing plate

In case of changing installation points, if you attach fixing plates alone at desired points of place, you will be able to use the single Jib Crane effectively by mounting and dismounting it.

### Example of use

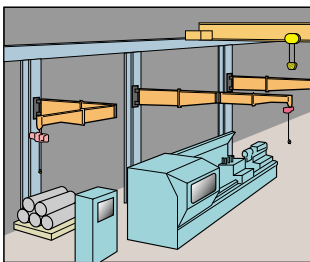

The crane is installed just beside the machine to attach or detach the work material. Install the crane on the pillar of the building to do auxiliary work under the overhead traveling crane.

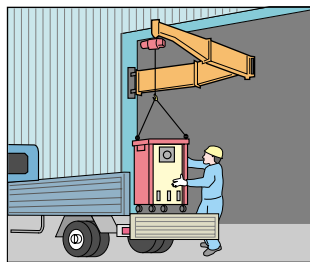

You can load or unload goods to or from the truck by installing the crane at the entrance of the factory or the warehouse. You can use the crane for lifting and moving the welding machine, tools, etc.

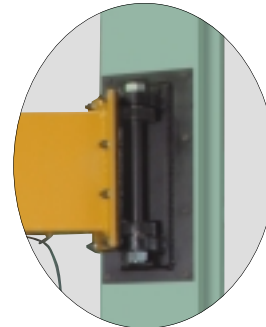

### Connection to the pillar

(to be fixed with bolts and nuts)

If the pillar is stronger than specified, you will be able to freely set the height of installation. (Installation is to be made by the user.)

### Dimensions of the fixing plate

(Unit:mm)

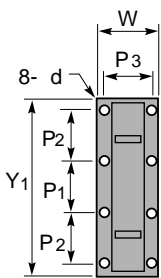

Item No.	W	Y1	P1	P2	P3	d
JBC 1520HF	210	480	150	150	180	14
JBC 1530HF						
JBC 1540HF						
JBC 2520HF	230	550	180	170	200	14
JBC 2530HF						
JBC 2540HF						
JBC 4820HF						
JBC 4830HF	280	665	225	200	240	18
JBC 4840HF						

### Dimensions of the hook for attaching a hoist

(Unit:mm)

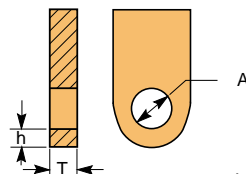

	A	T	h
150kg	60	10	15
250kg	60	14	15
480kg	82	16	19

Apart from the indicated specifications, we will provide custom-ordered hooks according to the user's needs.

### SPECIFICATIONS・DIMENSIONS TABLE

(Unit:mm)

Item No.	Rated capacity (kg)	Arm length S	Weight (kg)	Remarks
JBC 1520HF	150	2,043	65	
JBC 1530HF		3,043	78	
JBC 1540HF		4,043	100	
JBC 2520HF	250	2,036	102	
JBC 2530HF		3,036	129	
JBC 2540HF		4,036	156	
JBC 4820HF		2,038	197	
JBC 4830HF	480	3,038	251	
JBC 4840HF		4,038	291	

### Equipment with a load sensor

Model	Item No.	
Bolt,Nut Type	JBC 1520HFS	New series
	JBC 1530HFS	
	JBC 1540HFS	
	JBC 2520HFS	
	JBC 2530HFS	
	JBC 2540HFS	
	JBC 4820HFS	
	JBC 4830HFS	
	JBC 4840HFS	

You will be separately charged for freight and installation.