

# JIB CRANE (Floor fixed/-Arm-joint type)

JBC 1520K ~ 4840K

Universal joint type

Fixation of the crane on any place of the concrete slab with anchor bolts

Feature

Optimal for the place where there is no pillar around and the ceiling is too high except for the concrete slab  
 Assembly and disassembly of the Arm is very easy.

Hoist is to be separately purchased

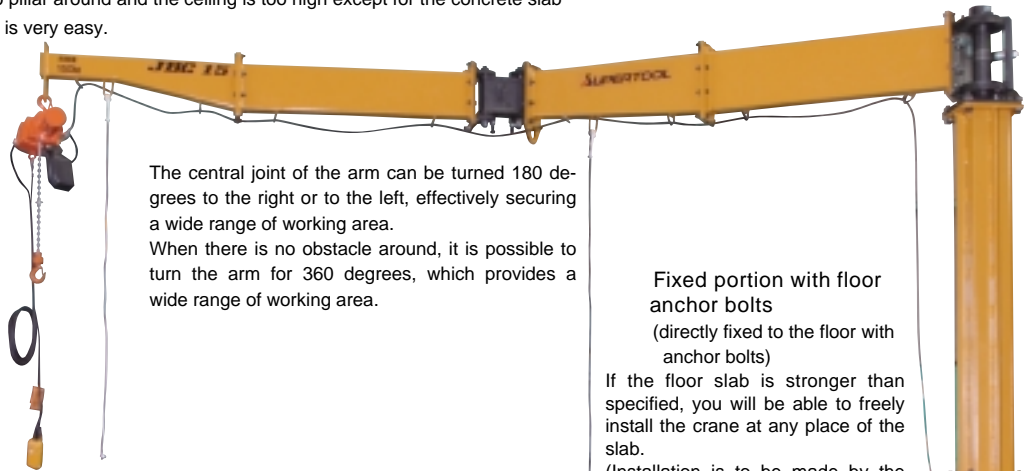

The central joint of the arm can be turned 180 degrees to the right or to the left, effectively securing a wide range of working area.  
 When there is no obstacle around, it is possible to turn the arm for 360 degrees, which provides a wide range of working area.

Fixed portion with floor anchor bolts  
 (directly fixed to the floor with anchor bolts)

If the floor slab is stronger than specified, you will be able to freely install the crane at any place of the slab.  
 (Installation is to be made by the user.)

Example of use

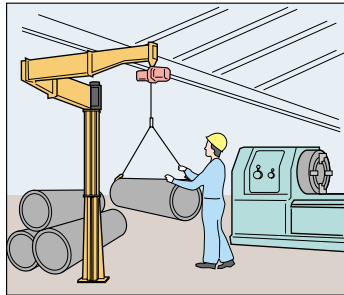

If you install the crane just beside a machine such as a large-sized lathe to attach or detach a workpiece to and from it, you will be able to enhance the working efficiency.

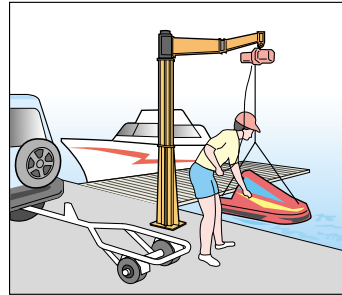

You can install the crane on the concrete quay of the sea, river, and lake to easily lift and lower work.

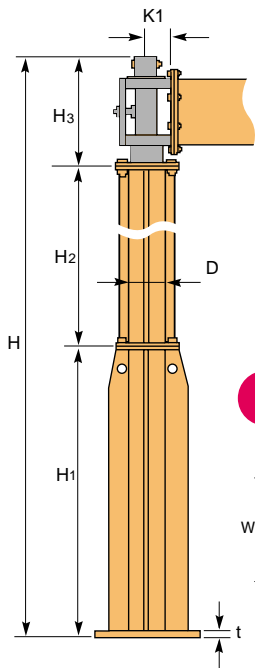
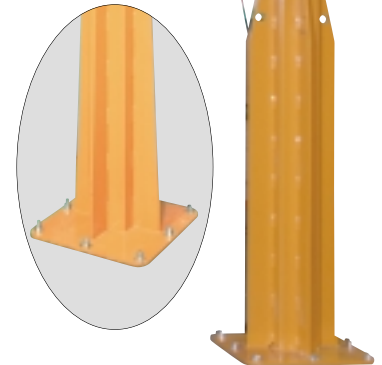

Dimensions of the floor fixture

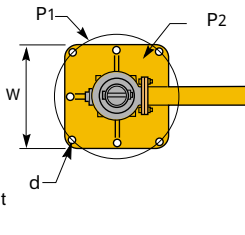

(Unit:mm)

Item No.	W	P1	P2	d
JBC 1520K				
JBC 1530K	500	600	450	20
JBC 1540K				
JBC 2520K				
JBC 2530K	500	600	450	20
JBC 2540K				
JBC 4820K				
JBC 4830K	600	700	550	24
JBC 4840K				

Apart from the indicated specifications, we will provide custom-ordered hooks according to the user's needs.

Dimensions of the hook for attaching a hoist

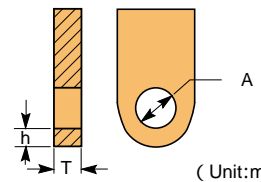

(Unit:mm)

	A	T	h
150kg	60	10	15
250kg	60	14	15
480kg	82	16	19

## SPECIFICATIONS • DIMENSIONS TABLE

(Unit:mm)

Item No.	Rated capacity (kg)	Lifting height (m)	H	H <sub>1</sub>	H <sub>2</sub>	H <sub>3</sub>	t	D	Arm length S	Weight (kg)
JBC 1520K	150	3.0	3,260	1,430	1,430	400	18	150	1,987	258
JBC 1530K									2,987	282
JBC 1540K									3,987	306
JBC 2520K	250	3.0	3,250	1,385	1,385	480	18	180	1,968	340
JBC 2530K									2,968	373
JBC 2540K									3,968	406
JBC 4820K	480	3.0	3,355	1,400	1,400	555	25	200	1,958	531
JBC 4830K									2,958	581
JBC 4840K									3,958	631

## Equipment with a load sensor

Model	Item No.	New series
Floor fixed Type	JBC 1520KS	
	JBC 1530KS	
	JBC 1540KS	
	JBC 2520KS	
	JBC 2530KS	
	JBC 2540KS	
	JBC 4820KS	
JBC 4830KS		
JBC 4840KS		

You will be separately charged for freight and installation.